



22 Carmichael Street Raymond Terrace, NSW

Prime Industrial Shed Available for Lease in Raymond Terrace CBD!

A fantastic opportunity awaits in the heart of Raymond Terrace's bustling commercial hub.

Features:

- Approx. 364m2 warehouse.
- Reception Area complete with a split system air conditioner.
- Office off the reception area.
- Kitchen room.
- Separate Male & Female Amenities.
- Private Shower.
- Roller Door, providing access for deliveries and shipments.
- 3 Phase Power.
- Approximately 6 Rear Car Spaces.
- Nestled in the heart of Raymond Terrace's commercial CBD, enjoy proximity to essential a



Melissa Parkinson

Jessica Nebauer

0414 484 234

Internal 364 m² External 15 m² Land Size m²



22 Carmichael Street, Raymond Terrece

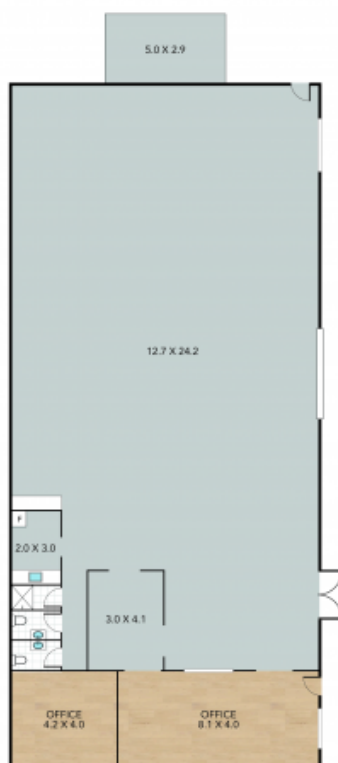

NOTE: Every precaution has been taken to verify the accuracy of the above details. However, prospective purchasers are advised to make their own enquiries.