

28 Dairyman Drive Raymond Terrace, NSW

 4  2  2

Style, Beauty and Elegance

Welcome to 28 Dairyman Drive! This stunning home is situated in Potter's Lane, offering a perfect blend of comfort, convenience, and style, nestled in a picturesque neighbourhood with fantastic street appeal.

Surrounded by quality homes, this magnificent Coral Home is perfect for investors and large families looking for space and functionality in a sought-after subdivision.

Key features include:

?- Master bedroom features a walk-in robe, ceiling fan and ensuite that has a large vanity, shower, and toilet.

?- Beautiful central bathroom features a shower, bath, and vanity, plus a separate toilet.

Don't miss out on the opportunity to make this your dream home! Contact us today to arrang

Price: \$850,000 - \$880,000

Council Rates: \$414.00 p/q

Water Rates: \$203.00 p/q



Liam Osborn

0447 822 460

Gerard Cunningham

0473 490 423

28 Dairyman Drive, Raymond Terrace



4 x 2 x 2 x



GROUND FLOOR

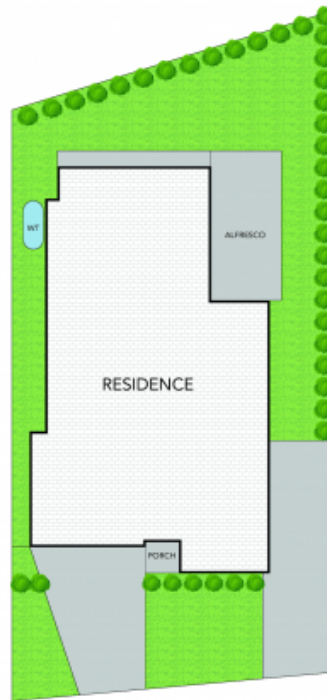

SITE PLAN



NOTE: Every precaution has been taken to verify the accuracy of the above details. However, prospective purchasers are advised to make their own enquiries.