



2 Edinburgh Street Raymond Terrace, NSW

 2  1  1

Begin here first

Set on 601m², this neat and tidy two-bedroom home is perfect for first home buyers, or a great investment opportunity with plenty of room for a deck or extension. The large corner block also provides loads of potential for a shed, or granny flat (subject to council approval).

All prospective buyers will benefit from its proximity to the CBD, schools, Muree Golf Club and Boomerang Park.

Key features include:

- Spacious lounge room features a reverse cycle air conditioner and a ceiling fan.
- Two good size bedrooms.
- The kitchen features an upright electric stove and vinyl flooring.
- Carpet in the lounge room and bedrooms.
- Tiled bathroom has a shower and basin.

Price: Price not disclosed

Council Rates: \$368.00 p/q

Water Rates: \$202.99 p/q



Liam Osborn

0447 822 460

Joel Osborn

0432 566 245

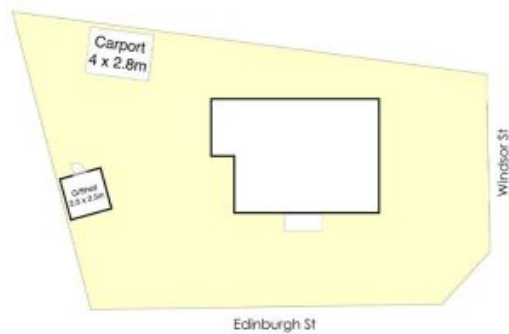
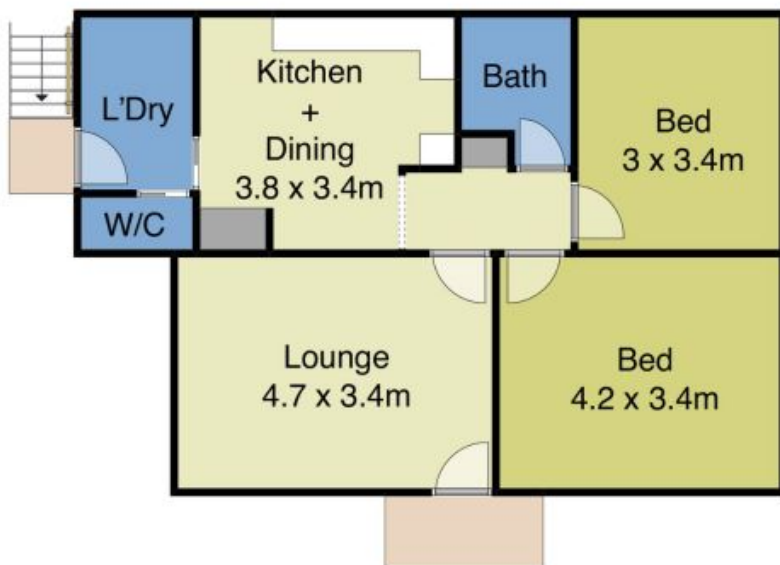

**OSBORN
GEORGE**

2 Edinburgh Street, Raymond Terrace



NOT TO SCALE

Disclaimer: This plan and measurements are for informational purposes only. We make no warranties or representations, express or implied, as to the accuracy of the data. Independent detail verification is recommended.