



## 6 Kanway Close Raymond Terrace, NSW

 4  2  2

Prestigious home with spectacular views.

This stunning four-bedroom home is positioned with the best views the area has to offer. The home also features 2 bathrooms, three toilets and multiple living areas which is guaranteed to satisfy your desire for quality and space!

Beautifully presented, this luxury tri level, split home has certainly been designed for the growing family.

Entertaining is easy with indoor and outdoor living areas, both formal and casual. Also enjoy relaxing on the upstairs balcony that looks out over the stunning pool area through to the spectacular lagoon and river.

This stunning residence is in a quality, safe neighbourhood and all on an 836m2 block in a quiet cul-de-sac.

Key features include:

Upper level

- Large, living room had a sliding glass door that leads to the balcony with views over th

**Price:** \$966000

**Council Rates:** \$460.00 p/q



**Joel Osborn**

0432 566 245

**Liam Osborn**

0447 822 460

\*Measurements to be used as a guide only.

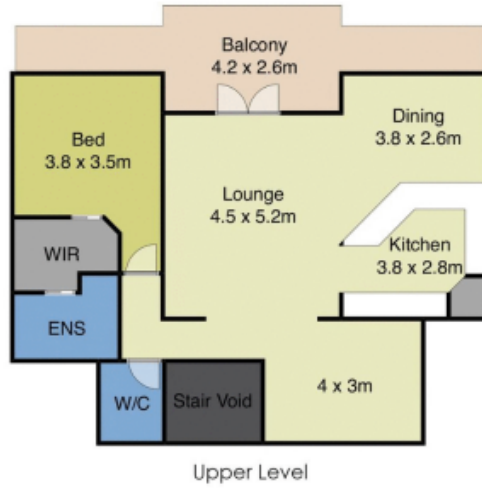
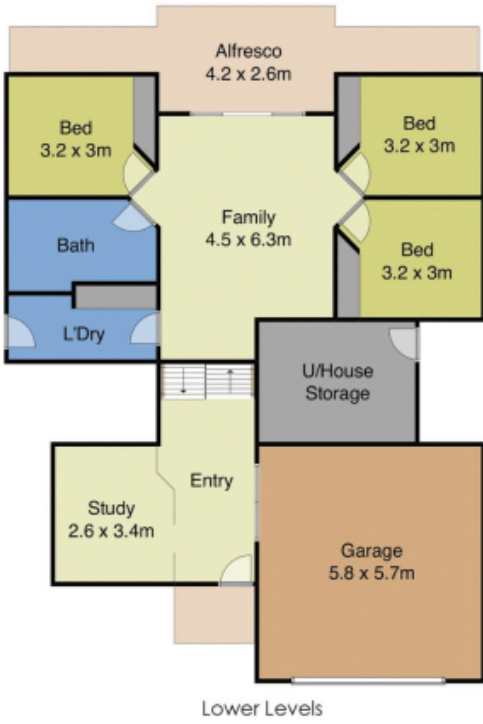

6 Kanway Close, Raymond Terrace

