



5 Smiths Lane Raymond Terrace, NSW

 3
  1
  1

Centrally located, walking distance to it all!

Attention retirees, first home buyers, downsizers, and investors. Do not miss out on a great opportunity to secure this well built, great size three-bedroom home, which is located close to the Muree Golf Club, Boomerang Park, schools, bus stops, and the CBD.

It has three large bedrooms and a formal lounge room. The dining and living room open to the modern kitchen at the rear, with a glass sliding door to the covered deck area.

Key features include:

- Large main bedroom features a built-in robe.
- Bedrooms two and three are a good size, and each have built-in robes.
- Modern kitchen includes under bench oven, electric cooktop, and rangehood.
- Linen cupboard storage.

Price: \$548,500



Joel Osborn

0432 566 245

Joel Osborn

0432 566 245

5 Smiths Lane, Raymond Terrace

Internal 100 m² External 216 m² Land Size 316m²

3 x  1 x  1 x 



GROUND FLOOR

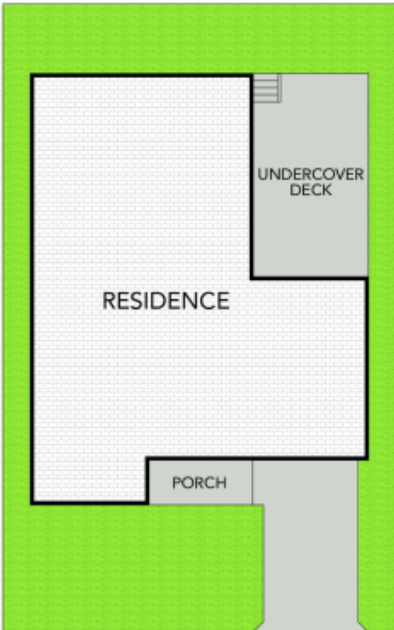

SITE PLAN

NOTE: Every precaution has been taken to verify the accuracy of the above details. However, prospective purchasers are advised to make their own enquiries.