



60 Martens Avenue Raymond Terrace, NSW

 4  2  2

Secluded Gem, with great side access!

Absolutely nothing to do or spend on this magnificent home. Step inside and be impressed with a practical layout that provides both space and functionality. Relax in the alfresco area overlooking the huge, landscaped backyard or take advantage of the walking/ bicycle track at your doorstep, that meanders throughout Lakeside. Centrally located in the Lakeside area, close to the schools, bus stops and shops, which provide great family appeal.

Key features include:

- Modern open plan kitchen includes a stainless-steel gas cooktop, under bench oven, rangehood and dishwasher.
- Tiles to entry, hall, living, dining room and kitchen.
- Separate formal lounge room has neutral carpet and a ceiling fan.
- Carpet in all bedrooms.
- Two linen press cupboards.
- Large sliding glass door leads from the living room to the tiled alfresco area, with a n

Price: \$735000



Liam Osborn

0447 822 460

Joel Osborn

0432 566 245

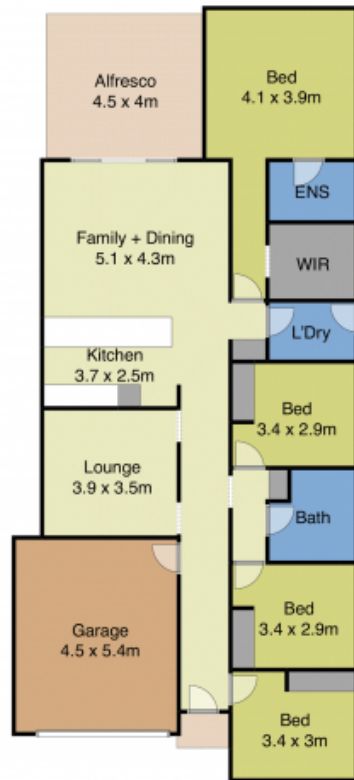

OSBORN
GEORGE

60 Martens Avenue, Raymond Terrace



NOT TO SCALE

Disclaimer: This plan and measurements are for informational purposes only. We make no warranties or representations, express or implied, as to the accuracy of the data. Independent detail verification is recommended.