



20 Beaton Avenue Raymond Terrace, NSW

 3  2  2

Spectacular Family Home!

Set on 585m², this well-presented family home is perfectly located on an elevated block of land, providing convenient access to nearby bus stops, schools, and shopping centre.

This is a wonderful opportunity for first home buyers and investors to secure a great three-bedroom, two-bathroom home in a sought-after part of Raymond Terrace.

Key features include:

- Large light filled lounge room.
- Kitchen includes dishwasher, under bench oven, gas cooktop and rangehood.
- Ducted air conditioning throughout.
- Separate toilet.
- Double garage features two remote doors, additional workshop area, drive thru access for

Price: \$657500

Council Rates: \$397.00 p/q



Joel Osborn

0432 566 245

Liam Osborn

0447 822 460

20 Beaton Avenue, Raymond Terrace

Internal 135 m² External 447 m² Land Size 582 m²

3 x  2 x  2 x 



GROUND FLOOR

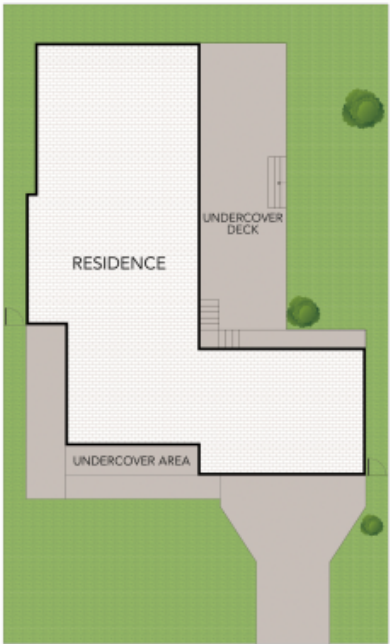

SITE PLAN

NOTE: Every precaution has been taken to verify the accuracy of the above details. However, prospective purchasers are advised to make their own enquiries.