

**25 Ralstons Road Nelsons Plains, NSW**

5 3 6

**Magnificent Rural Estate, Grand Design!  
Elevated Rural Home, set on 18.48 acres**

Exciting opportunity to secure a stunning elevated rural property close to town. With beautiful rural views and a masterbuilt executive family residence, its easy to see why the current owners have loved living in their peaceful piece of paradise for over 20 years.

The front entry door is adorned with a lead light fleur de lis pattern, lighting up the room. This leadlight theme runs through the home and is featured in bedroom 3 and the garage, creating perfect symmetry.

Decorative cornicing, plasterboard moldings, ceiling roses and pendant lights adorn all rooms with ceilings heights of 2.750m & 3.700m.

The reception areas are in grand style, a sunken lounge room with a centrally located gas

**Price:** Price not disclosed

**Council Rates:** \$506.00 p/q



**Tracy Jonovski**

0418 216 275

**Liam Osborn**

0447 822 460

# 25 Ralstons Road, Nelsons Plains

Internal 369 m<sup>2</sup> External 183 m<sup>2</sup> Land Size 74,076 m<sup>2</sup>

5 x  3 x  3 x 

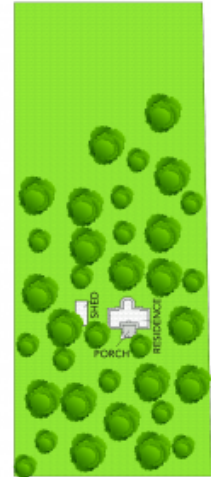

SITE PLAN

**NOTE:** Every precaution has been taken to verify the accuracy of the above details. However, prospective purchasers are advised to make their own enquiries.