

**10 Milkhouse Drive Raymond Terrace, NSW**

 4    
  2    
  2

**Relaxing Lifestyle in New Estate**

This immaculately presented home offers a relaxing lifestyle you have been searching for and in a beautiful part of town. This outstanding home is perfectly positioned within the recently sold-out Potter's Lane Estate, and overlooks a nature reserve from the front aspect. Available 14/4/22.

**Price:** \$650 pw

**Features:**

- ~ Spacious open plan design
- ~ Covered alfresco area for entertaining
- ~ Beautiful main bedroom with an ensuite, walk-in robe and ceiling fan
- ~ Remaining three bedrooms with built-in robes and ceiling fans
- ~ Carpet in all bedrooms
- ~ Large main bathroom with bath, vanity, shower, and separate toilet
- ~ Modern open plan kitchen that flows onto the dining and living rooms
- ~ Centrally located lounge room



**Paulette Dehne-James & Rachel Farrugia**

# 10 Milkhouse Drive, Raymond Terrace

Internal 173 m<sup>2</sup> External 412 m<sup>2</sup> Land Size 585 m<sup>2</sup>

4 x  2 x  2 x 



GROUND FLOOR

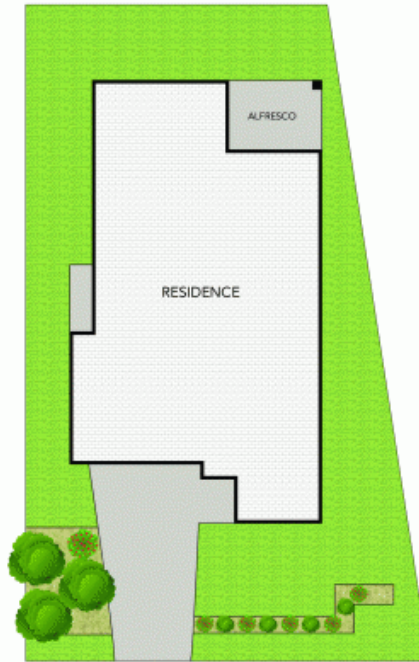

SITE PLAN

**NOTE:** Every precaution has been taken to verify the accuracy of the above details. However, prospective purchasers are advised to make their own enquiries.