



6 Elwin Road Raymond Terrace, NSW

3 2 4

All the work is done!

This beautiful three-bedroom home ticks all the boxes, with the hard work already done. Entertain around the sparkling in ground swimming pool or relax inside with the ducted air conditioning throughout.

Situated within walking distance to Grahamstown Public School, Irrawang High School, Lakeside shops and the Lakeside Tavern, making this fantastic property is a must see.

Key features include:

- Three large bedrooms with built in robes. The main bedroom also has an ensuite.
- Stunning country style kitchen with waterfall stone bench tops.
- Beautiful pebble concrete in ground swimming pool.
- Large lounge room with step up dining room.
- Covered outdoor area.
- Good size laundry.

Price: \$760000

Council Rates: \$385.00 p/q



Liam Osborn

0447 822 460

Joel Osborn

0432 566 245

6 Elwin Road, Raymond Terrace

Internal 196 m² External 388 m² Land Size 584 m²

3 x  2 x  2 x 



NORTH

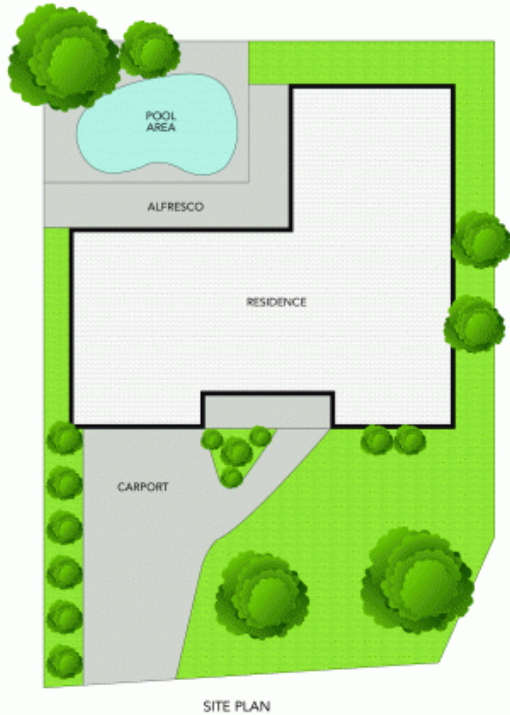

NOTE: Every precaution has been taken to verify the accuracy of the above details. However, prospective purchasers are advised to make their own enquiries.