



21 Holwell Circuit Raymond Terrace, NSW

 4
  2
  2

First Class Location!

You cannot help but be impressed by the great view out over the reserve and bushland from the rear entertaining area. The home's appealing features continue inside with the four bedrooms, ensuite, galley kitchen and centrally located 3-way bathroom all come together to make this a great family home. Set on an enviable 775sqm block, the home features a secure backyard, which creates a tranquil spot to sit and enjoy the local wildlife.

Large expanses of manicured grassed areas beyond the fenced yard with gated access ensures the space is perfect to explore the nature reserve.

Whether you are a first homebuyer or an investor this house is an opportunity not to be missed.

Key features include:

- Open living room / dining area has a fan and air-conditioning
- Kitchen includes upright stove/ oven

Price: \$510000

Council Rates: \$365.00 p/q

Water Rates: \$415.00 p/q



Joel Osborn

0432 566 245

Liam Osborn

0447 822 460

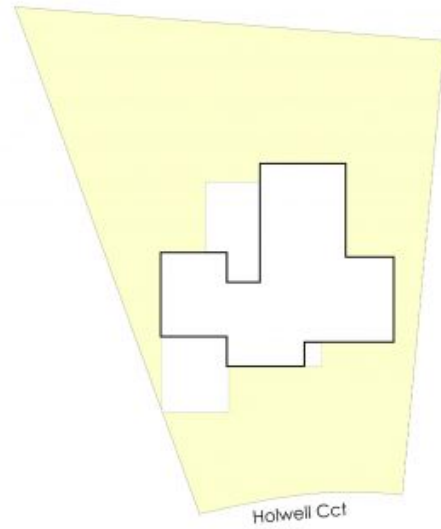
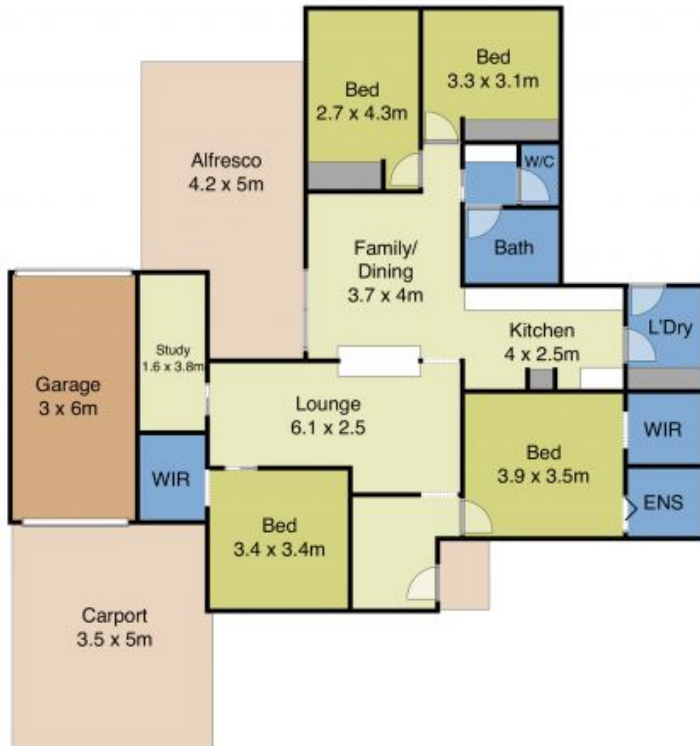

21 Holwell Circuit, Raymond Terrace



NOT TO SCALE

Disclaimer: This plan and measurements are for informational purposes only. We make no warranties or representations, express or implied, as to the accuracy of the data. Independent detail verification is recommended.