



10 Walker Crescent Raymond Terrace, NSW

 4  2  2

Golf Course Living!

A wonderful chance for the keen golfer to grab something special. Split over two levels, the lower level offers two living areas, a bedroom, powder room, laundry and a covered deck area with North West views to the ranges. The upper level has the main bathroom, two good sized bedrooms and a main bedroom with an ensuite.

Located opposite the Muree Golf Club and within walking distance to the shopping centre and schools gives this property real buyer appeal.

Key features include:

- Spacious main bedroom features an ensuite, built in robe and ceiling fan.
- All three remaining bedrooms have built in robes and one has a ceiling fan.
- Open kitchen / dining living room has air conditioning.
- Separate family room.

Price: \$585000

Council Rates: \$330.00 p/q

Water Rates: \$722.00/year (approx)



Joel Osborn

0432 566 245

Liam Osborn

0447 822 460

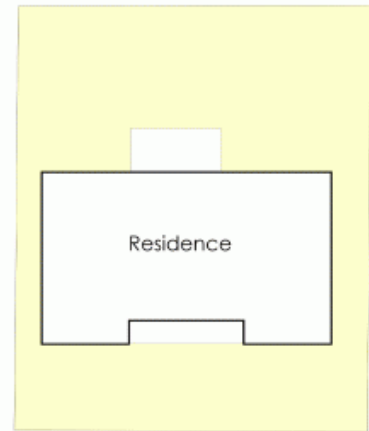

Walker Cres



10 Walker Crescent, Raymond Terrace



NOT TO SCALE

Disclaimer: This plan and measurements are for informational purposes only. We make no warranties or representations, express or implied, as to the accuracy of the data. Independent detail verification is recommended.