



8/24 Bowman Drive RAYMOND TERRACE, NSW

 2  1  1

LITTLE GEM

Set on 110m² in a secure location, this two bedroom unit is a little gem. Spacious living area with reverse cycle air conditioning in lounge and dining area. Well-appointed kitchen with loads of bench space. Both queen-sized bedrooms have built in robes and ceiling fans. The private backyard is maintenance free with a covered sitting area with an easterly aspect. Remote control operated single lock up garage with internal access. Strata fees costs are \$361.36 per quarter. Expected rental return \$260.00 – \$275.00 per week.

Price: \$215,000 - \$235,000



Tracy Jonovski

0418 216 275



Raymond Terrace

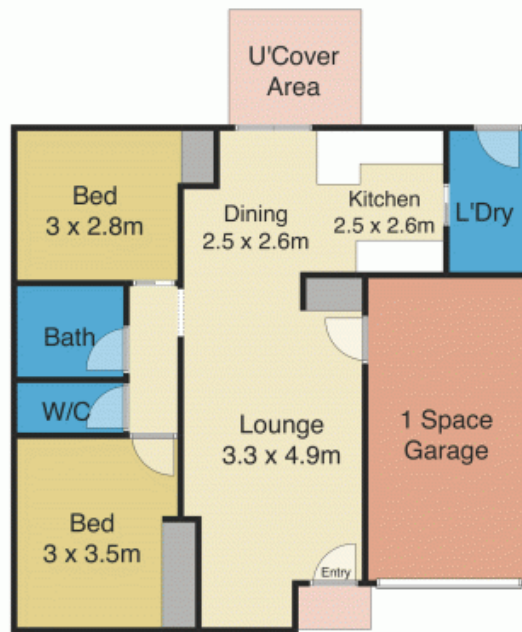

Measurements are approximate
and are to be used only as a guide

8/24 Bowman Dr, Raymond Terrace