



**1/171 Benjamin Lee Drive RAYMOND TERRACE, NSW**

3   1   1

**Private living!**

Situated in the sought-after Lakeside area, this beautiful three bedroom unit is tucked away and benefits from its private location. Perfect for investors, first home buyers and downsizers searching for comfort and affordability in a great part of town.

**Price:**                   \$340000

**Key features include:**

- Three good size bedrooms with built-in robes.
- Open plan kitchen and dining room which features new vinyl flooring. The modern kitchen includes a stainless steel rangehood, cooktop and oven.
- Reverse cycle air conditioning in the dining room.
- Spacious bathroom with shower and bath. Separate toilet and vanity.
- Single garage with internal access.
- Big laundry with second toilet.
- Covered outdoor area.



**Liam Osborn**

0447 822 460

**Liam Osborn**

0447 822 460

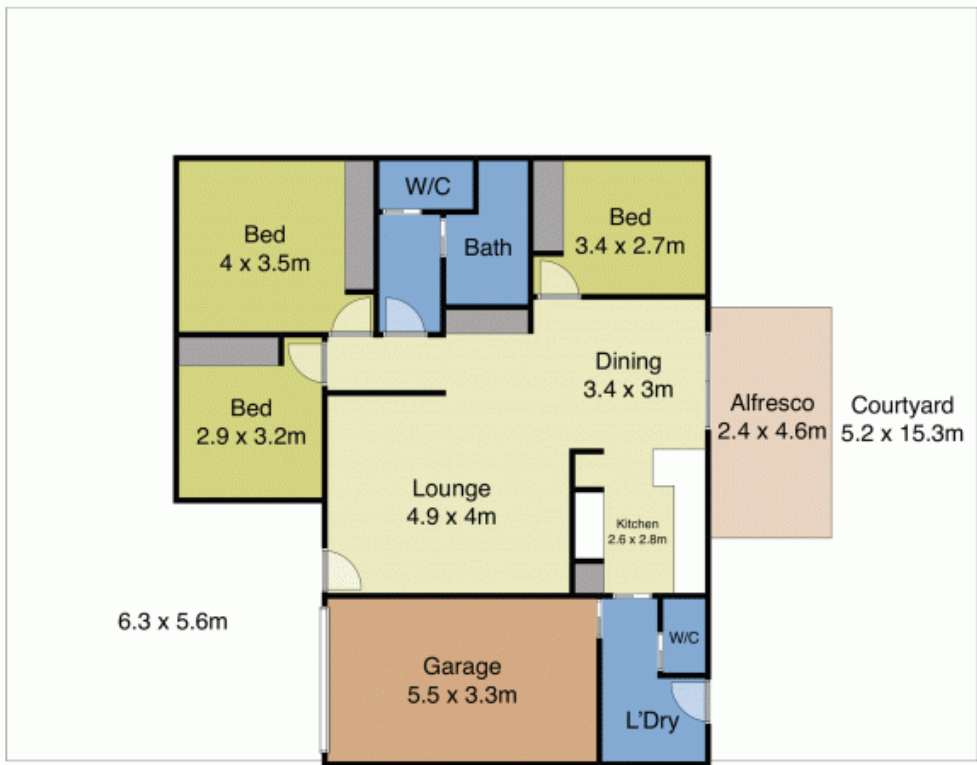

1/171 Benjamin Lee Drive, Raymond Terrace



**NOT TO SCALE**  
 Disclaimer: This plan and measurements are for informational purposes only. We make no warranties or representations, express or implied, as to the accuracy of the data. Independent detail verification is recommended.