



49 Holwell Circuit RAYMOND TERRACE, NSW

3 1 1

Here is a real charmer

Set on 599m2, this beautiful three-bedroom home is situated in one of the best locations Raymond Terrace has to offer, taking in beautiful views of the reserve located at the rear of the property. Do not miss out on this incredible opportunity.

Price: Market Preview

Key features include:

- Three spacious bedrooms featuring ceiling fans and built-in robes.
- Open plan kitchen and dining room. The dining room also has a reverse cycle air conditioner and a ceiling fan.
- Big bathroom which features a shower, bath, separate toilet and vanity.
- Big lounge room at the front of the home which includes a ceiling fan.
- Garden shed.



Joel Osborn

0432 566 245

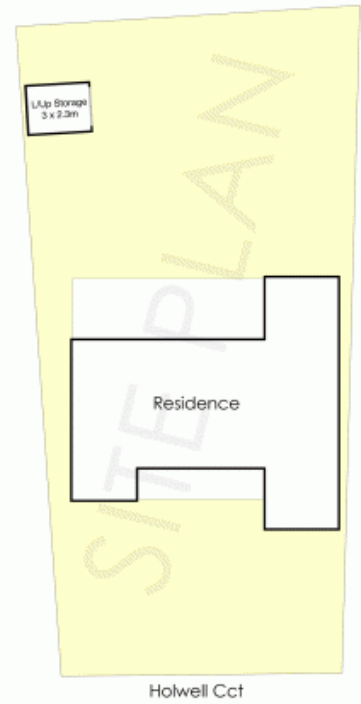
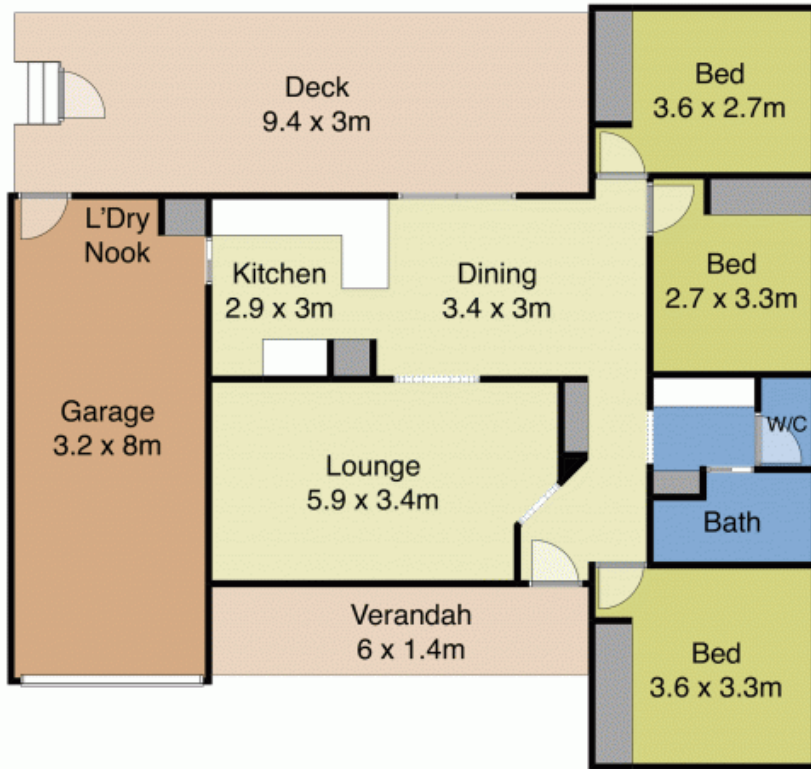

LJ Hooker
 Raymond Terrace | Medowie

49 Holwell Circuit, Raymond Terrace



NOT TO SCALE

Disclaimer: This plan and measurements are for informational purposes only. We make no warranties or representations, express or implied, as to the accuracy of the data. Independent detail verification is recommended.