



108 Alton Road RAYMOND TERRACE, NSW

3 1 1

Your kind of home!

Set on 578m², this elevated home has a lovely outlook which boasts a functional and open floor plan. It features light, neutral tones with fresh paint, flooring and quality carpets. Positioned close to schools, transport and the CBD, this well presented home offers opportunity for investors and first home buyers.

Other features include:

- Large main bedroom with built-in robe, ceiling fan and reverse cycle air conditioner.
- Bedroom two and three are both good size. Bedroom two also has a ceiling fan.
- Open plan kitchen and dining, with air conditioning in the dining room.
- Functional bathroom with a shower, bath and vanity.
- Separate toilet.
- Easy access storage.
- Large entertainers lounge room.
- Single lock up garage with electric roller door and reverse cycle air conditioning.

Price: \$373000



Liam Osborn

0447 822 460

Liam Osborn

0447 822 460

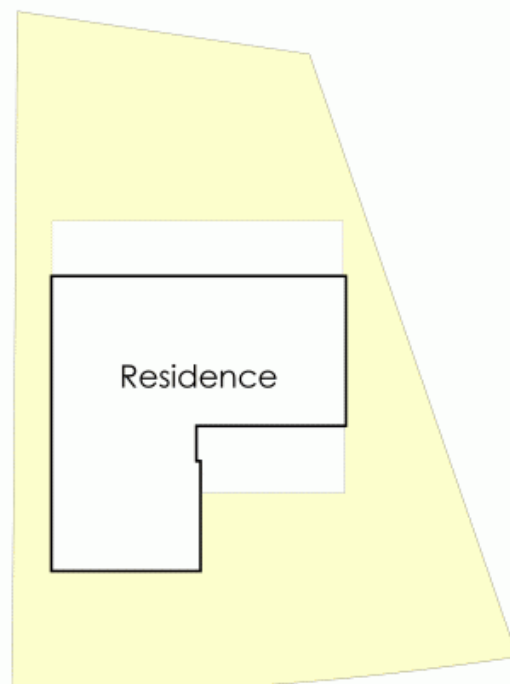
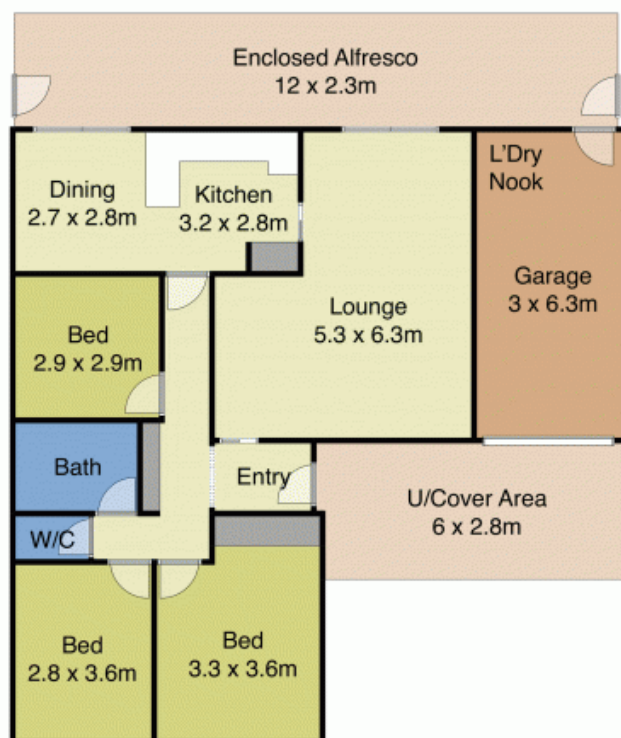

Alton Rd

