



15 Chifley Drive RAYMOND TERRACE, NSW

 4  1  3

A REAL FAMILY HOME

Beautifully presented and maintained and has been in the family since new. It offers 4 bedrooms (3 with built-ins), the lounge has air conditioning and combustion fire, formal dining, generous kitchen & meals area. There is a separate sunny craft/sitting room and the delightful screened outdoor area overlooks the yard. Single garage plus carport and a covered spot for the boat or van. Lovely quiet location and easy walk to shops, school, etc. Its hard to fault.

Price: \$295,000

Osborn George

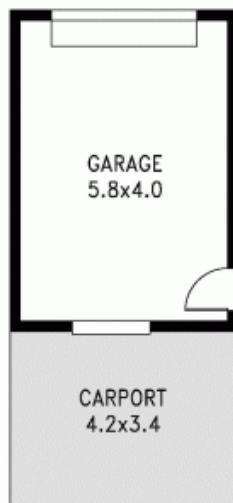
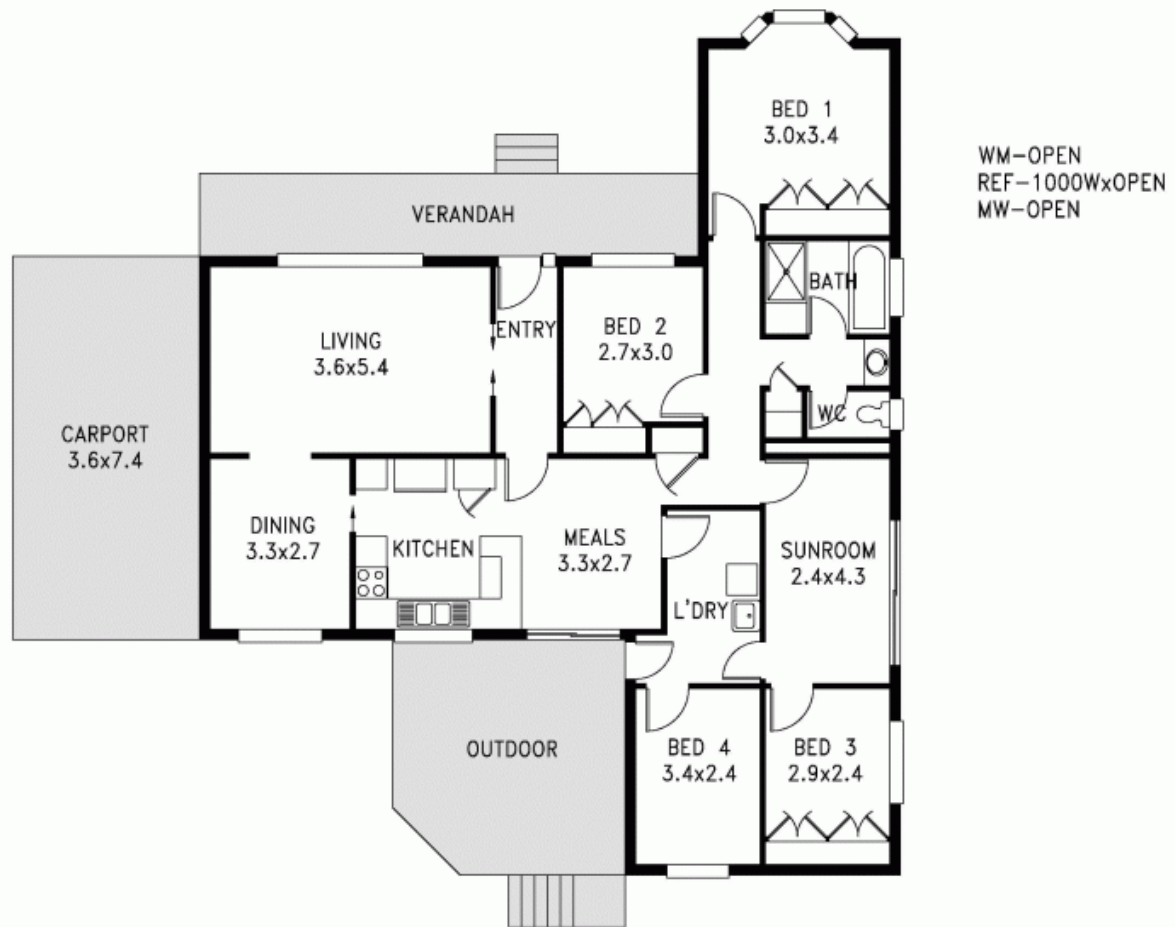

FLOOR AREA: 129.45M²
 VERANDAH & OUTDOOR: 38.00M²
 GARAGE & CARPORT: 64.80M²

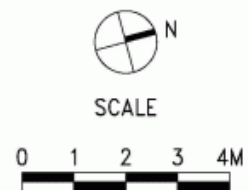

ADDRESS: 15 CHIFLEY DRIVE RAYMOND TERRACE

Disclaimer-Plan shown is only indicative of layout/furniture/landscaping. Plans are for advertising purposes only and should not be considered exact. Plan National Pty Ltd accepts no responsibility for errors in this plan.