



79 Adelaide Street Raymond Terrace, NSW

4 2 1

Central location, with loads of potential and a self-contained granny flat!

Set on 506m², this neat and tidy three bedroom home is situated close to town and is opposite Roslyn Park, providing loads of appeal for all prospective buyers. It also benefits from a self-contained granny flat, which would be great for growing families and investors. Centrally located and just a short stroll to the main shopping centre, schools, parks and sporting oval, making this property a must see.

Key features include:

- Main lounge room features a reverse cycle air conditioner.
- Three good size bedrooms which all have carpet, two feature built-in robes.
- The kitchen includes electric stove and rangehood.
- Cyprus pine timber floors in the lounge room and hallway.
- Separate toilet.
- One bedroom with a built-in robe, ensuite which features a shower, vanity and separate t

Price: \$425000

Council Rates: \$324.00 p/q

Water Rates: \$710.00/year (approx)



Liam Osborn

0447 822 460

Joel Osborn

0432 566 245

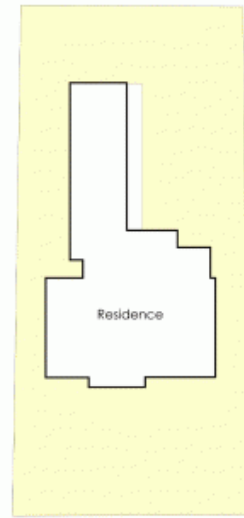
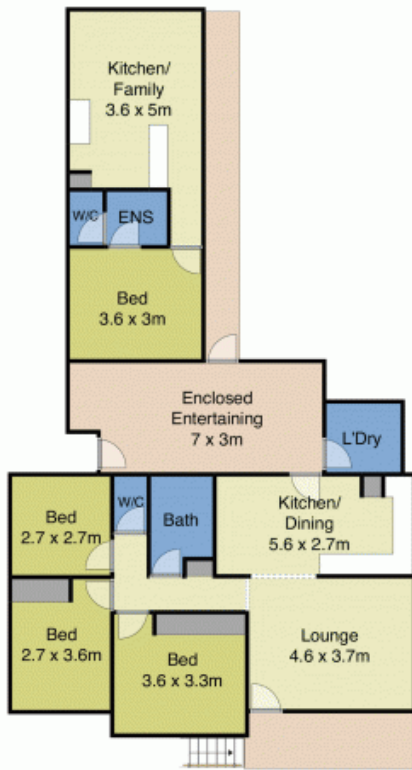

Adelaide St



79 Adelaide Street, Raymond Terrace



NOT TO SCALE

Disclaimer: This plan and measurements are for informational purposes only. We make no warranties or representations, express or implied, as to the accuracy of the data. Independent detail verification is recommended.